



10 Pines Road
, Bickley, BR1 2AA

£3,200 PCM

 4
  0
  0
  C

10 Pines Road

, Bickley, BR1 2AA

Available to view is this four bedroom, two reception room detached home with approx. 100' garden. Set on approx. 1/4 acre plot, located on a popular road and close to Bullers Wood school, Bickley Park school and Bickley station.

FRONT

HALLWAY

RECEPTION ROOM

22'7" x 15'10" (6.88 x 4.83)

CONSERVATORY

22'7" x 7'2" (6.88 x 2.18)

DINING ROOM

15'9" x 13'3" (4.8 x 4.04)

KITCHEN/BREAKFAST ROOM

13'3" x 11'0" (4.04 x 3.35)

UTILITY ROOM

BEDROOM FOUR

13'2" x 9'10" (4.01 x 3)

STUDY

13'2" x 9'9" (4.01 x 2.97)

STAIRS TO FIRST FLOOR LANDING

FIRST FLOOR LANDING

BEDROOM ONE

18'3" x 13'3" (5.56 x 4.04)

DRESSING ROOM

ENSUITE SHOWER ROOM

SEPARATE WC





BEDROOM TWO
15'9" x 11'3" (4.8 x 3.43)

BEDROOM THREE
15'8" x 11'1" (4.78 x 3.38)

BATHROOM

GARDEN
100'0" (30.48)



GARAGE
18'0" x 16'0" (5.49 x 4.88)

DIRECTIONS



Floor Plan

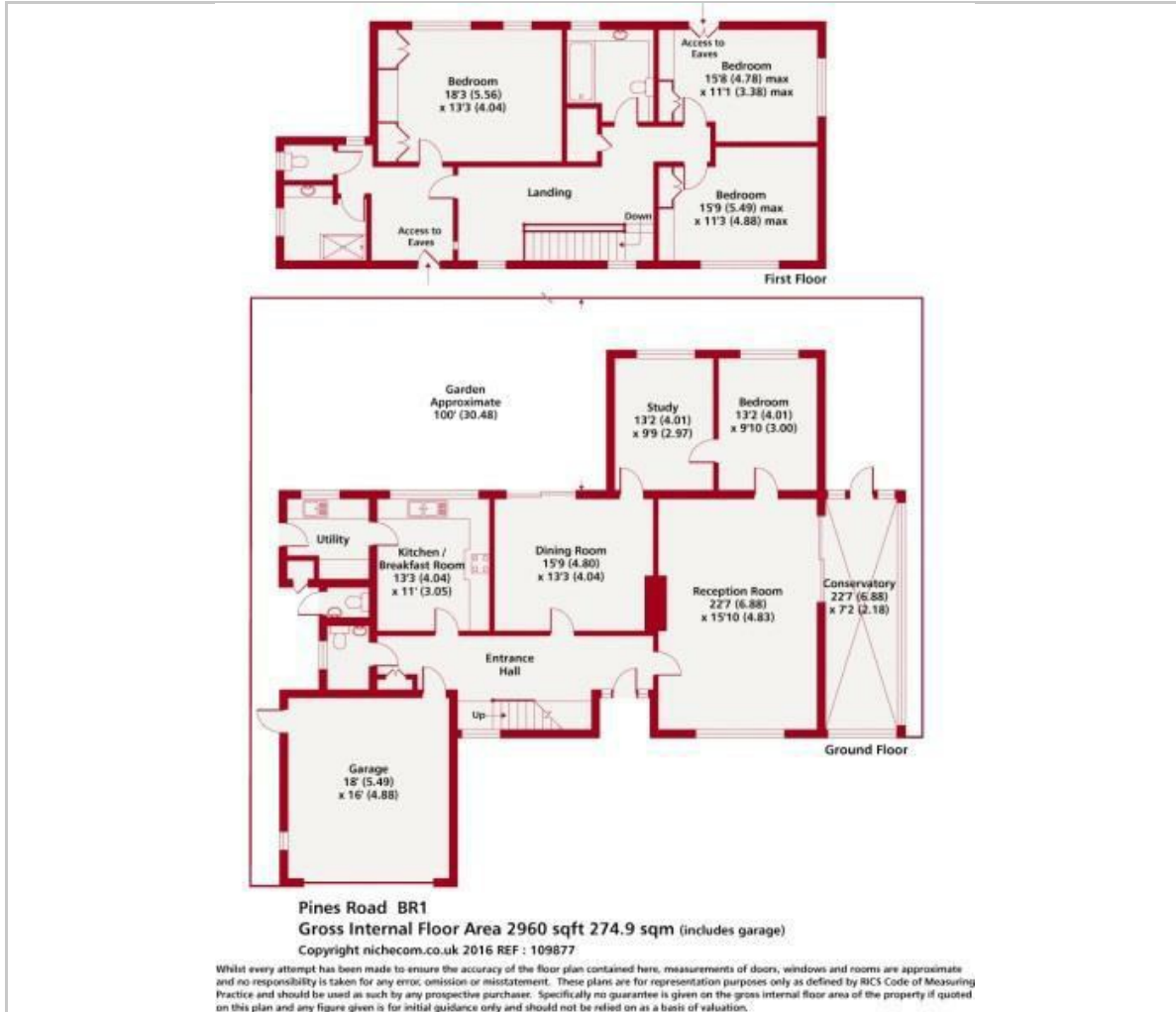

Viewing

Please contact our Petts Wood Office on 01689 819991 if you wish to arrange a viewing appointment for this property or require further information.

These particulars, whilst believed to be accurate are set out as a general outline only for guidance and do not constitute any part of an offer or contract. Intending purchasers should not rely on them as statements of representation of fact, but must satisfy themselves by inspection or otherwise as to their accuracy. No person in this firm's employment has the authority to make or give any representation or warranty in respect of the property.

26 Station Square, Petts Wood, Kent, BR5 1NA
 Tel: 01689 819991 Email: pettswood@edmund.co.uk <https://www.edmund.co.uk/>

Area Map



Energy Efficiency Graph

