



£1,800 Per Month
39 Shepperton Road
Petts Wood, BR5 1DL
£1,800 Per Month



39 Shepperton Road

, Petts Wood, BR5 1DL

This three bedroom semi detached bungalow is located within a short walk to Petts Wood shops and station with access into Central. Benefits include a large through lounge into diner, utility room plus a study area. There is a well maintained garden to the rear and driveway parking to the front. This property is sure to attract much interest and as such your early viewing comes highly recommended.

FRONT

LOUNGE

13'11" x 12'2" (4.24 x 3.71)

DINING ROOM

12'4" x 9'10" (3.76 x 3)

KITCHEN

11'4" x 6'5" (3.45 x 1.96)

UTILITY ROOM

6'6" x 5'9" (1.98 x 1.75)

STUDY AREA

10'4" x 7'3" (3.15 x 2.21)

SHOWER ROOM

BEDROOM TWO

11'6" x 10'9" (3.51 x 3.28)

BEDROOM THREE

10'5" x 8'4" (3.18 x 2.54)

STAIRS TO FIRST FLOOR

BEDROOM ONE

13'2" x 12'8" (4.01 x 3.86)

GARDEN

33'5" x 24'9" (10.19 x 7.54)

DIRECTIONS





Floor Plan

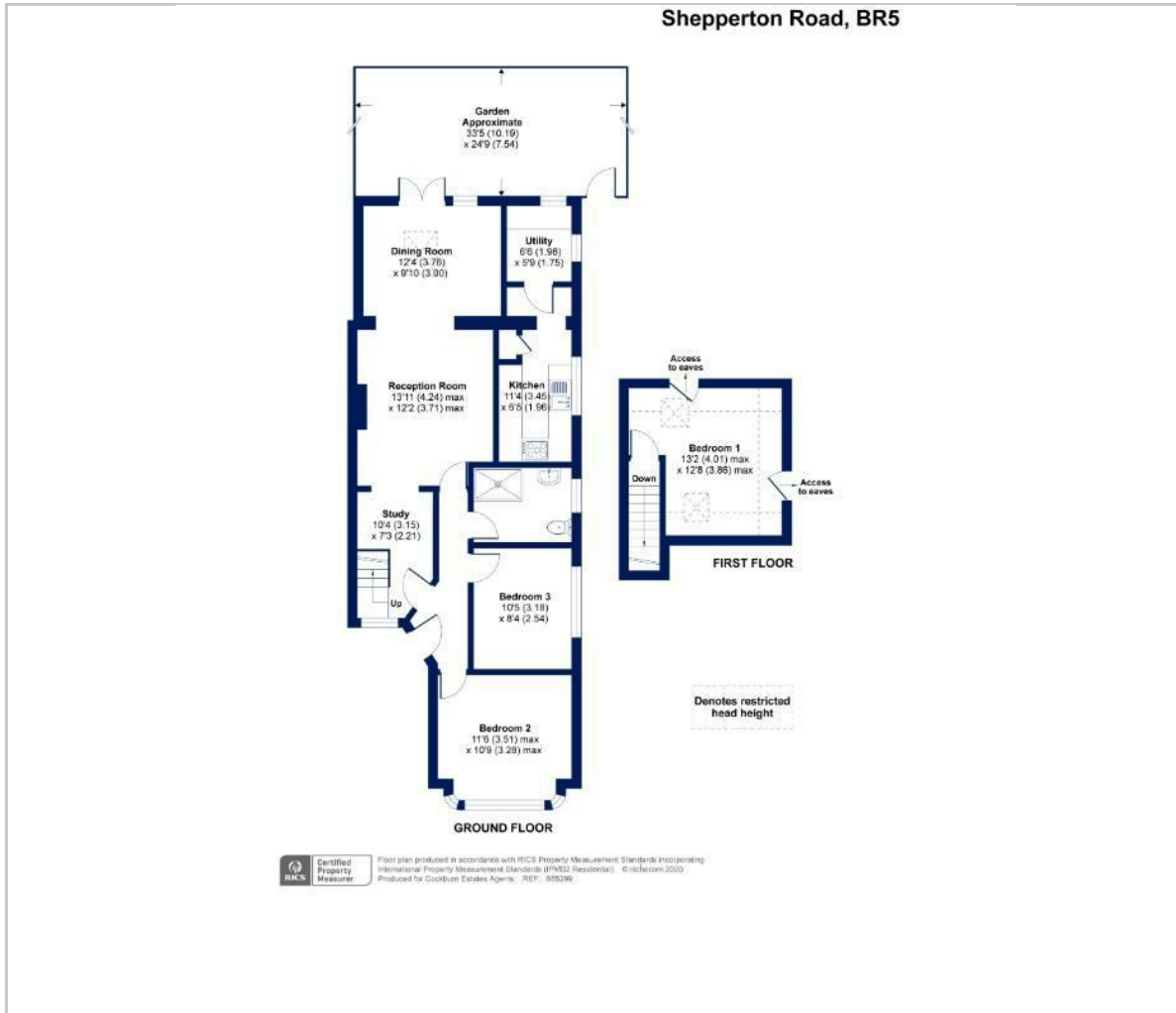

Viewing

Please contact our Petts Wood Office on 01689 819991 if you wish to arrange a viewing appointment for this property or require further information.

These particulars, whilst believed to be accurate are set out as a general outline only for guidance and do not constitute any part of an offer or contract. Intending purchasers should not rely on them as statements of representation of fact, but must satisfy themselves by inspection or otherwise as to their accuracy. No person in this firm's employment has the authority to make or give any representation or warranty in respect of the property.

26 Station Square, Petts Wood, Kent, BR5 1NA
 Tel: 01689 819991 Email: pettswood@edmund.co.uk <https://www.edmund.co.uk/>

Area Map



Energy Efficiency Graph

