



Crofton Lane Petts Wood BR6 0BP

£2,600 PCM



- Detached House
- Three Bedrooms
- Two Reception Room
- Bathroom plus Ensuite
- Stunning 75' approx garden
- Council Tax Band G
- Holding Fee is 1 weeks rent (£600.00 at £2600pcm)
- Deposit is 5 weeks rent (£3,000 at £2600pcm)



A well presented, detached, 3 bedroom family home; which is offered to the market in good condition and features a beautiful garden and delightful kitchen/breakfast room. This property is located within convenient reach of Crofton and Perry Hall Schools, as well as Petts Wood and Orpington Stations.

FRONT

Driveway parking to front.

LOUNGE

14'4 x 13'9 (4.37m x 4.19m)

KITCHEN

16'6 x 14'4 (5.03m x 4.37m)

SITTING ROOM

24'1 x 11'8 (7.34m x 3.56m)

GROUND FLOOR WC

LANDING

BEDROOM ONE

19'10 x 12'8 (6.05m x 3.86m)

ENSUITE

BEDROOM TWO

14' x 10'4 to wardrobe front (4.27m x 3.15m to wardrobe front)

BEDROOM THREE

7'11 x 7' (2.41m x 2.13m)

BATHROOM

GARDEN

75' approx (22.86m approx)

DIRECTIONS

From Petts Wood, Station Square, proceed down Fairway and right into Tudor Way. Left at mini-roundabout into Towncourt Lane and across next mini-roundabout into Crofton Lane.



Road Map

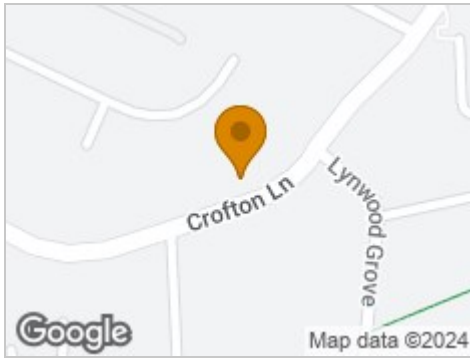

Hybrid Map



Terrain Map

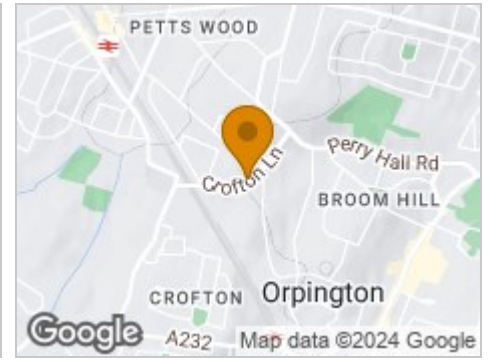

Floor Plan

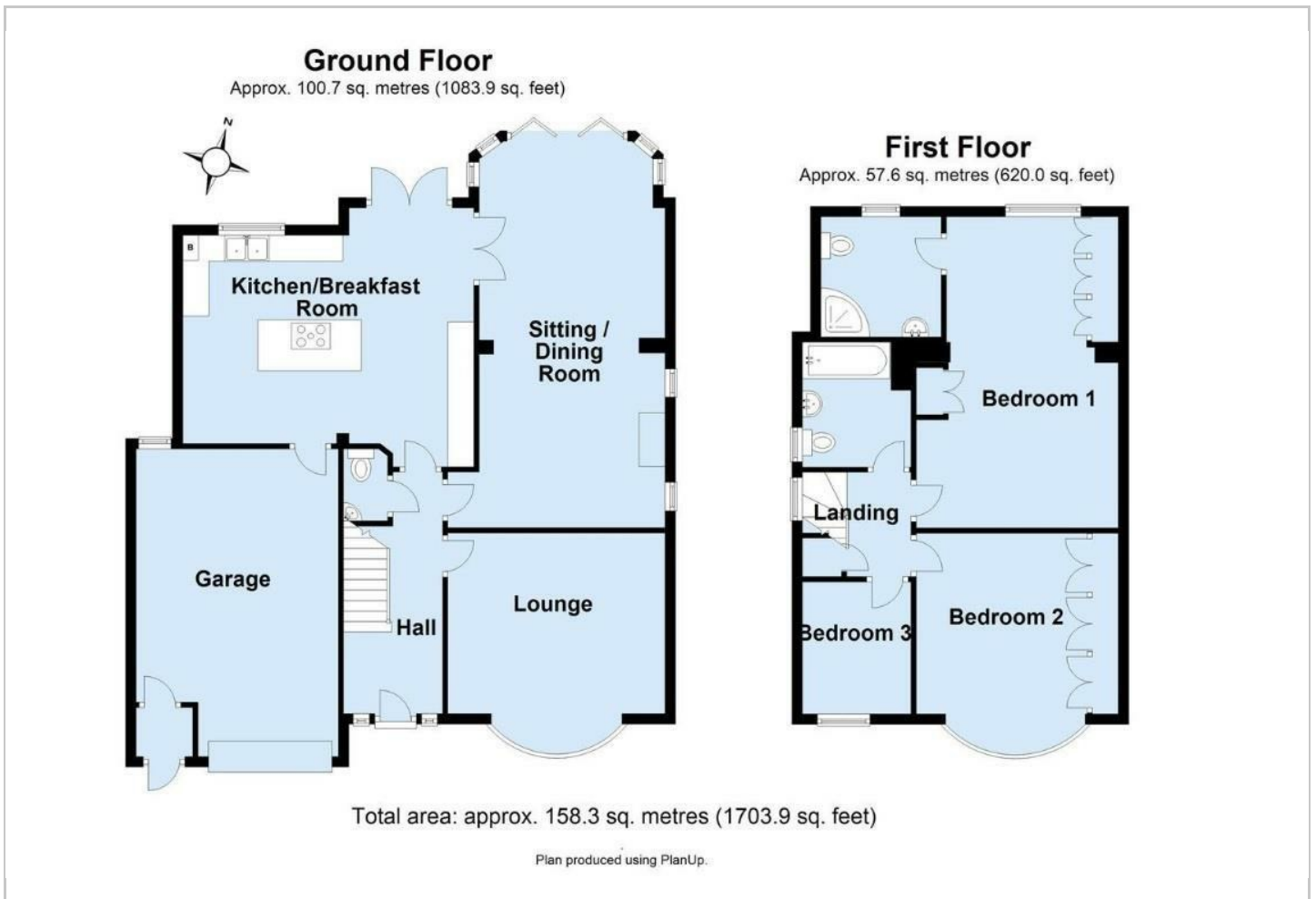

Viewing

Please contact our Petts Wood Office on 01689 819991 or pettswood@edmund.co.uk should you wish to arrange a viewing appointment for this property or require further information.

Energy Efficiency Graph

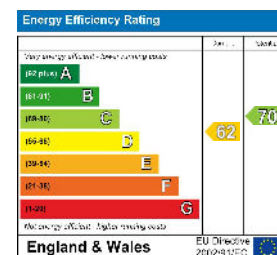

These particulars, whilst believed to be accurate are set out as a general outline only for guidance and do not constitute any part of an offer or contract. Intending purchasers should not rely on them as statements of representation of fact, but must satisfy themselves by inspection or otherwise as to their accuracy. No person in this firm's employment has the authority to make or give any representation or warranty in respect of the property.