



## 84 Maxwell Gardens, Orpington, Kent, BR6 9QU

Tastefully decorated 3 bedroom semi detached conveniently located for highly regarded schools and within easy access of Station and High Street

- Highly regarded area
- 3 bedrooms
- Fitted kitchen
- Modern bathroom suite
- Lounge/dining room
- Double glazed
- Gas central heating
- Private garden
- Garage
- Off street parking

**£535,000**

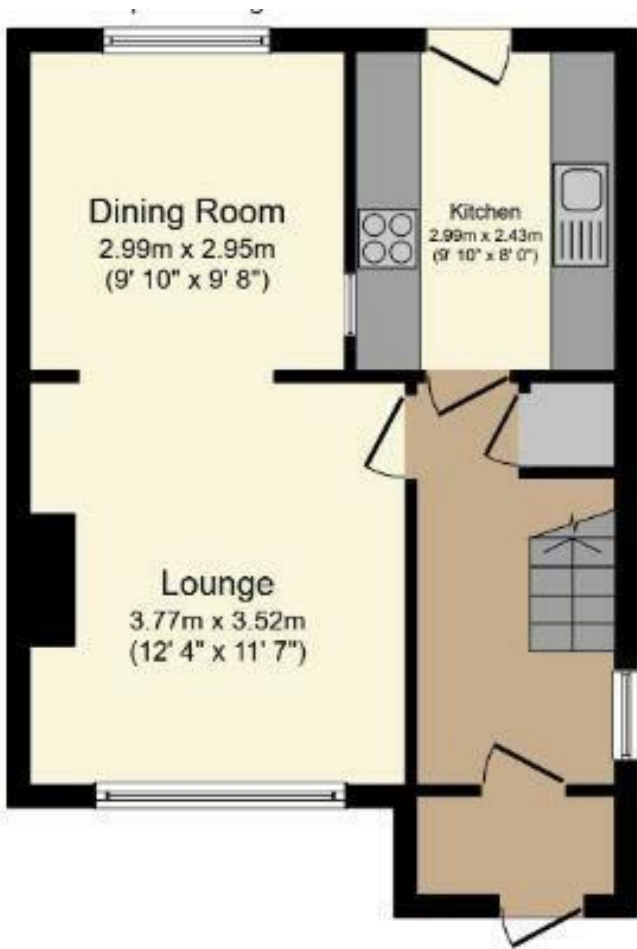

**Ground Floor**

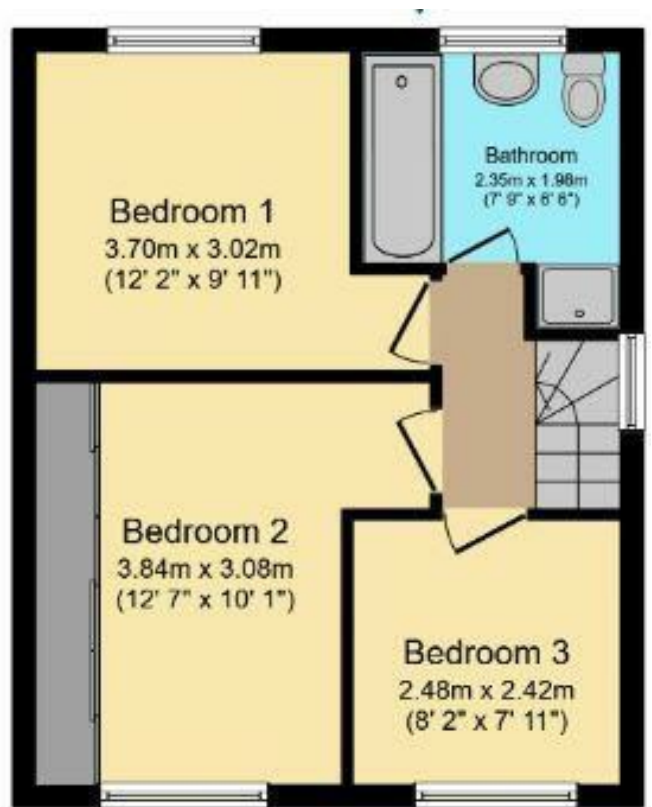

**First Floor**

Total floor area 78.0 sq. m. (840 sq. ft.) approx

Energy Efficiency Rating		Current	Potential
<i>Very energy efficient - lower running costs</i>			
(92 plus) <b>A</b>			
(81-91) <b>B</b>			
(69-80) <b>C</b>			
(55-68) <b>D</b>			
(39-54) <b>E</b>			
(21-38) <b>F</b>			
(1-20) <b>G</b>			
<i>Not energy efficient - higher running costs</i>			
<b>England &amp; Wales</b>		EU Directive 2002/91/EC	

86

67