



£1,650 Per Month
36 Elmcroft Road
, Orpington, BR6 0HY
£1,650 Per Month



36 Elmcroft Road

, Orpington, BR6 0HY

A delightful 2 bed home, ideally located for all local amenities & ready for immediate occupation. Recently refurbished to a high level throughout, & boasting two double bedrooms, this property is sure to attract much interest & your early viewing comes highly recommended.

Kitchen

16 x 5'1 (4.88m x 1.55m)

Living / Dining Room

10'10 x 22'2 (3.30m x 6.76m)

Master Bedroom

14'2 x 10 (4.32m x 3.05m)

Bedroom 2

11'9 x 9'6 (3.58m x 2.90m)

Bathroom

8'5 x 5'8 (2.57m x 1.73m)





Floor Plan

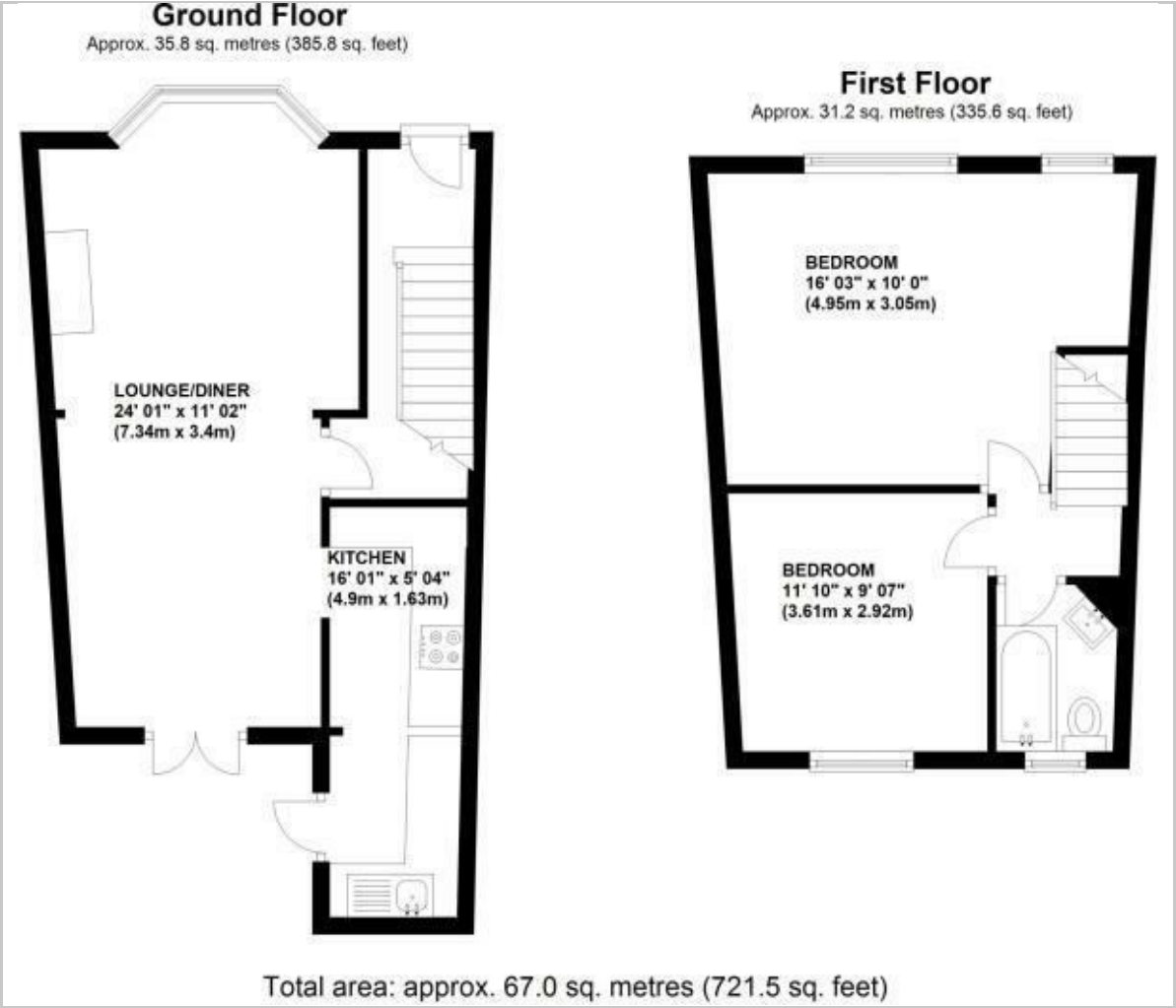

Viewing

Please contact our Petts Wood Office on 01689 819991 if you wish to arrange a viewing appointment for this property or require further information.

These particulars, whilst believed to be accurate are set out as a general outline only for guidance and do not constitute any part of an offer or contract. Intending purchasers should not rely on them as statements of representation of fact, but must satisfy themselves by inspection or otherwise as to their accuracy. No person in this firms employment has the authority to make or give any representation or warranty in respect of the property.

26 Station Square, Petts Wood, Kent, BR5 1NA
Tel: 01689 819991 Email: pettswood@edmund.co.uk <https://www.edmund.co.uk/>

Area Map

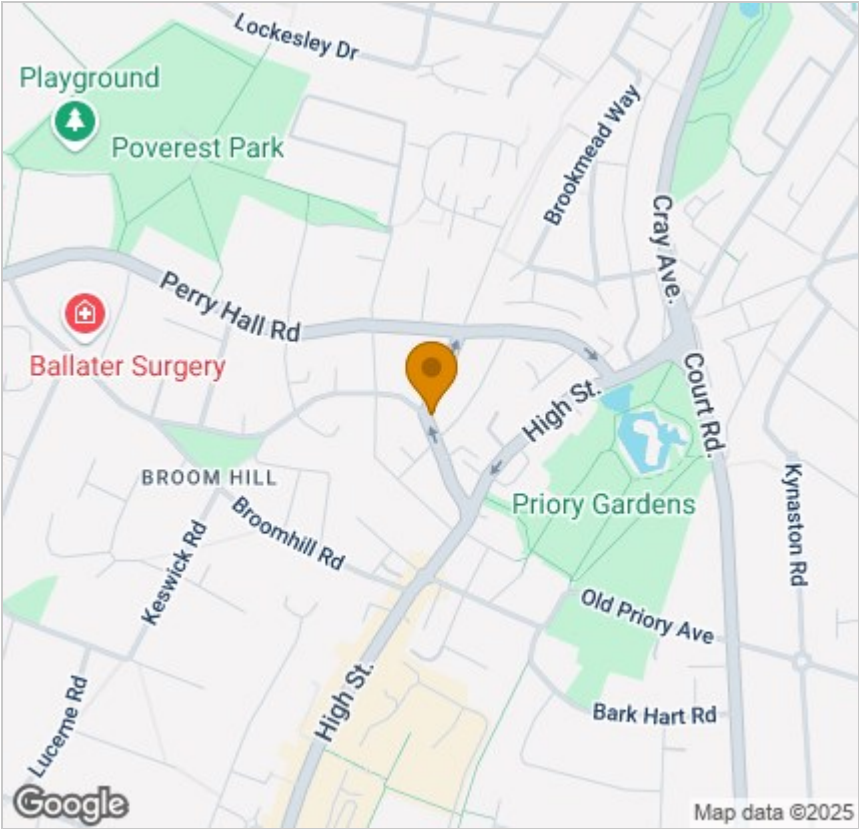

Energy Efficiency Graph

