



21 Cudham Lane North, Green Street Green, Kent, BR6 6BX

Nestled in the charming area of Green Street Green, this delightful semi-detached house on Cudham Lane North which needs modernising offers a wonderful opportunity for those seeking a tranquil lifestyle. The property is chain-free, making it an ideal choice for a smooth and hassle-free purchase.

Set in a semi-rural location, this home boasts a large garden, perfect for families or anyone who enjoys outdoor space. The expansive garden provides ample room for gardening, entertaining, or simply relaxing in the fresh air.

Additionally, the property benefits from off-street parking, ensuring convenience for residents and visitors alike. This feature is particularly valuable in a serene neighbourhood where space is often at a premium.

With its appealing setting and generous outdoor area, this house presents a fantastic opportunity for those looking to embrace a peaceful lifestyle while still being within reach of local amenities. Whether you are a first-time buyer or seeking a new family home, this property is well worth considering to.

- Chain free semi detached house
- Downstairs toilet
- Large garden
- Semi rural location
- In need of modernisation
- Off street parking
- Walking distant to local shops, schools and pubs.
- Walking distance to High Elms country park
- Council Tax D
- EPC to be confirmed

£600,000

GROUND FLOOR
585 sq.ft. (54.3 sq.m.) approx.



1ST FLOOR
433 sq.ft. (40.2 sq.m.) approx.

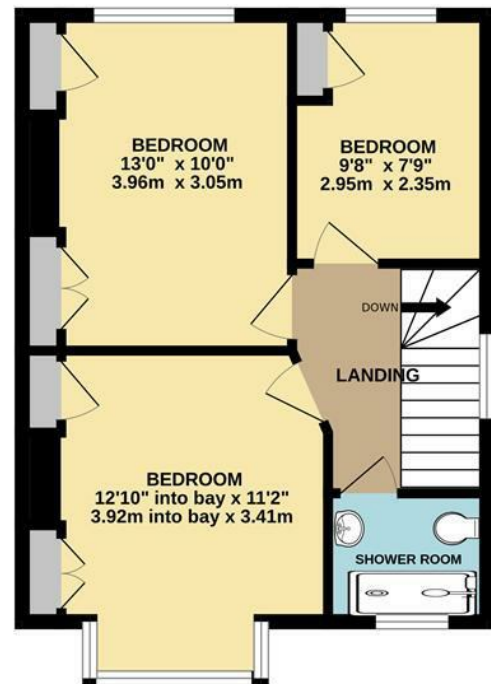

TOTAL FLOOR AREA: 1017 sq.ft. (94.5 sq.m.) approx.

Whilst every attempt has been made to ensure the accuracy of the floorplan contained here, measurements of doors, windows, rooms and any other items are approximate and no responsibility is taken for any error, omission or mis-statement. This plan is for illustrative purposes only and should be used as such by any prospective purchaser. The services, systems and appliances shown have not been tested and no guarantee as to their operability or efficiency can be given.
Made with Metropix ©2025

| Energy Efficiency Rating | | |
|---|----------------------------|-----------|
| | Current | Potential |
| Very energy efficient - lower running costs | | |
| (92 plus) A | | |
| (81-91) B | | |
| (69-80) C | | |
| (55-68) D | | |
| (39-54) E | | |
| (21-38) F | | |
| (1-20) G | | |
| Not energy efficient - higher running costs | | |
| England & Wales | EU Directive 2002/91/EC | |